

# 205 SERIES

## Horizontal Hold Down Clamps | Product Overview

### Features:

- Smallest of the Horizontal Hold Down clamps
- Ideal for light duty clamping in tight spaces
- Stainless steel models furnished without plastic grip

### Applications:

- Assembly
- Closures
- Woodworking
- Light duty clamping

### Also Available:

See page MC-ACC-1 for accessories  
Accommodates M4 or #8 spindle accessory

**205-U**  
Flanged Base  
U-Bar

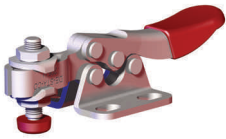

**205-UB** ⓘ  
Straight Base  
U-Bar

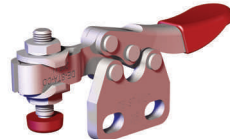

**205-UL** ⓘ  
Left Flanged  
Base, U-Bar

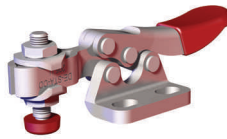

**205-UR** ⓘ  
Right Flanged  
Base, U-Bar

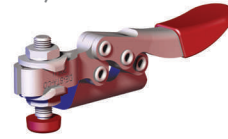

**205-USS**  
Flanged Base  
U-Bar, Stainless  
Steel



**205-S**  
Flanged Base  
Solid Bar



**205-SB** ⓘ  
Straight Base  
Solid Bar



**205-SL** ⓘ  
Left Flanged Base,  
Solid Bar

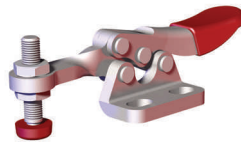

**205-SR** ⓘ  
Right Flanged  
Base, Solid Bar

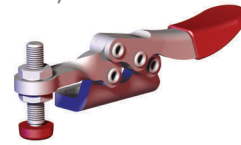

**205-SSS**  
Flanged Base  
Solid Bar, Stainless  
Steel



Note:  
Clamps shown with included accessories.

## Technical Information

Model	Max. Holding Capacity	Clamp Bar Opening (+10°)	Handle Opening (+10°)	Weight	Accessories (Supplied)		
					Spindle Assembly	Flanged Washers	
205-U	270N [60 lbf]	90°	80°	0,03kg [0.06lb]	205208-M	105106	
205-UB ⓘ							
205-UL ⓘ							
205-UR ⓘ	340N [75 lbf]	94°	82°		205943-M	105906	
205-USS							
205-S	270N [60 lbf]				94°	82°	205208-M
205-SB ⓘ							
205-SL ⓘ							
205-SR ⓘ	340N [75 lbf]			94°			82°
205-SSS							

ⓘ This item is available upon request

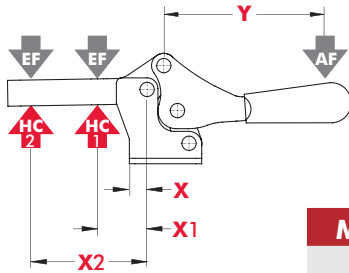

Model	X	X1	X2	Y	±HC1	±HC2	±EF(X1):AF	±EF(X2):AF
U		[0.43] 11			[60lbf.] 270N	[50lbf.] 220N	9:1	5:1
USS	[0.22] 5,6		[0.81] 20,5	[1.31] 33,2	[75lbf.] 340N	[65lbf.] 290N		
S		--			--	[60lbf.] 270N	--	4:1
SSS						[75lbf.] 340N		

Dimensions shown "mm [inch]" ± HC = Holding Capacity, EF = Exerting Force, AF = Applied Force  
Refer to See page MC-TEC-4 for additional information.

### Standard Clamp Dimensions | -U/-UB/-UL/-UR/-USS/-S/-SB/-SL/-SR/-SSS

**205-U**  
Flanged Base  
U-Bar

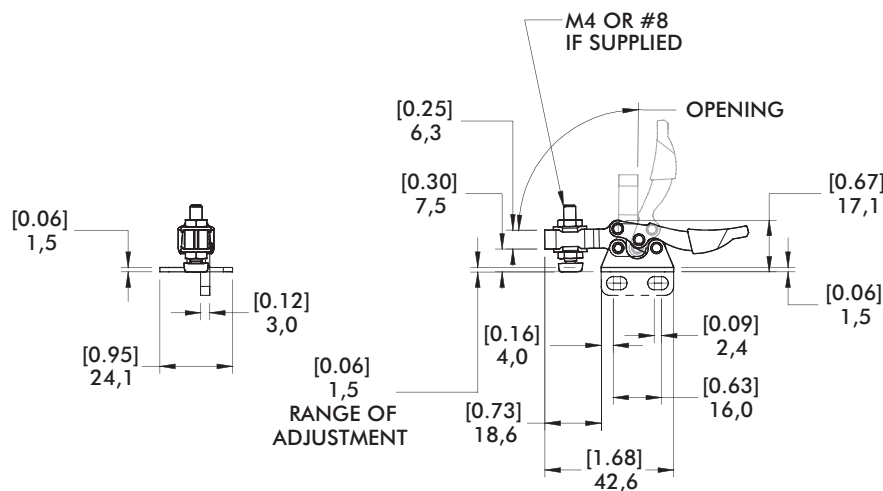
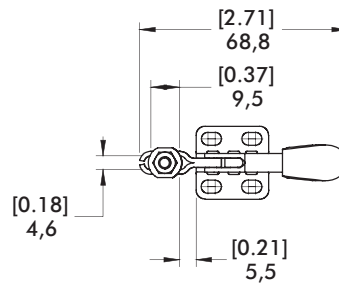

**205-S**  
Flanged Base  
Solid Bar

