



MOULDPRO

07.

TOOLS & ACCESSORIES

132 07.1 GATE CUTTERS 	133 07.2 DEBURRING TOOLS 	136 07.3 SOFT TOOLS 
139 07.4 ACCESSORIES 	140 07.5 POLISHING EQUIPMENT 	144 07.6 BRUSHES 
146 07.7 COMPRESSED AIR BLOW GUNS 	147 07.8 BORESCOPIES 	148 07.9 MEASURING TOOLS 
149 07.10 MAGNIFYING GLASSES 		

GATE CUTTERS

GATECUTTER 15° FLUSH CUT



Part No.	Cut Type	Size	Handle Type
P4	15° - flush cut	4" / 100 mm.	Soft Foam Grip
P40	15° - flush cut	4" / 100 mm.	Plastic Grip
P5	15° - flush cut	5" / 125 mm.	Soft Foam Grip
P50	15° - flush cut	5" / 125 mm.	Plastic Grip
P6	15° - flush cut	6" / 150 mm.	Soft Foam Grip
P60	15° - flush cut	6" / 150 mm.	Plastic Grip

GATECUTTER 40° FLUSH CUT



Part No.	Cut Type	Size	Handle Type
P6-40	40° - flush cut	6" / 150 mm.	Soft Foam Grip
P60-40	40° - flush cut	6" / 150 mm.	Plastic Grip

GATECUTTER 90° FLUSH CUT



Part No.	Cut Type	Size	Handle Type
P6-90	90° - flush cut	6" / 150 mm.	Soft Foam Grip
P60-90	90° - flush cut	6" / 150 mm.	Plastic Grip

Description:

High quality alloy steel.

Coil spring return provides fast smooth action and improves productivity Induction hardened cutting edge.

Black oxide, anti-glare finish reduces visual fatigue and corrosion.

Soft touch static dissipative anti-fatigue foam grips give maximum comfort.

CERAMIC KNIFE CONVEX



Part No.	Blade Material	Handle length	Blade Profile	
CR2000	Ceramic 1250 HV	135 mm.	Convexed	 1

CERAMIC KNIFE CONCAVE









Part No.	Blade Material	Handle length	Blade Profile	
CR2300	Ceramic 1250 HV	135 mm.	Concaved	 1

HEAT NIPPERS

HEATED GATE CUTTERS



Part No.	Blade Length (mm.)	Blade Type	Size (mm.)	Cut capacity (mm.)	Weight	
HT-120	10	End Cut	150	ø 4	270 g.	
HT-130	27	Long	165	ø 4	270 g.	
HT-140	22	Flat	160	ø 5	265 g.	
HT-160	16	Narrow	150	ø 6	240 g.	
HT-170	22	Angle	150	ø 7	250 g.	
HT-180	16	Standard	190	ø 8	250 g.	

TRANSFORMER 220V/240V



Part Code	Power input	Voltage output	Size (mm.)	Weight
HDT100	220/240 V.	24V.	80x85x130	1600 g.

SPARE HEATING ELEMENT



Part Code	Power input	Heat Effect
W-19	24V.	19 Watt

DE-BURRING/BRONZE PLIERS

DE-BURRING TOOL



Part No.	Type	Blade Material	No. of blades	Blade size ϕ	
E02000	Handle	Steel	1	3,2	1
BS1010	Replacement blades	Steel	10	3,2	1

BRONZE PLIER



Part No.	Description	Size
BC6	60° Needle Nose	6" / 150 mm

BRONZE PLIER



Part No.	Description	Size
BC9	60° Needle Nose	9" / 230 mm

BRONZE PLIER



Part No.	Description	Size
BL6	Straight Needle Nose	6"/ 150 mm

BRONZE PLIER



Part No.	Description	Size
BL9	Straight Needle Nose	9"/ 230 mm

BRONZE PLIER



Part No.	Description	Size
BD6	Side Cutter	6"/ 150 mm

Description:

High quality Bronze Pliers, reduce risk of damaging the mould

BEVELED BLADE SCRAPER



Part No.	Blade Width	Material
BSC125	32 mm.	Brass
BSC200	50 mm.	Brass

TOOLS & ACCESSORIES

ANGLED SCRAPER NO BEVEL



Part No.	Blade Width	Material
BSC125A	32 mm.	Brass

KNOCK OUT BAR



Part No.	Description	Size
704-31	Knock out Bar	ø 8
705-31	Replacement Bar	ø 8

Description:

Simple but effective tool that combines a tough steel rod with threaded brass replaceable tips that prevent damage to the mould surface. The quickly replaced threaded brass tip ensures that the rod never gets too short or wears out and minimises the risk of burning. The steel rod never wears out and the end will not 'mushroom' like a solid brass rod.

- Steel Rod has an anti rust finish
- Steel Rod has 10mm Flat for simple removal of used tips
- Brass Tip is machined to fine point
- Supplied complete with one replacement tip

Steel Rod: 13mm dia. / 420mm length
Brass Tip: 8mm dia. / 105mm length

BRASS TOOLS



Part No.	Description	Length
BRT5	5mm Diameter	350mm
BRT5/90	5mm Diameter / 90 Degree	350mm
BRT8	8mm Diameter	400mm
BRTK	Kit Comprising BRT5 / BRT5/90 / BRT8	

Description:

A range of brass hand tools manufactured from high grade brass for safely working on mould tools without damaging the mould surface; ideal for removing frozen sprues or stuck parts. The tips are supplied blunt and may be shaped to suit specific requirements.

HOT TIP SPRUE CLEANER



Part No.	Watt	Temp. Range	Power
PS6-5	200	350° C	230V.

Description

The Hot Tip Sprue Cleaner is a quick heating flexible tool for melting thermoplastics from plugged sprues and nozzles. When you squeeze the trigger the powerful heater immediately (10seconds) heats the tip to 350° C.

- 3 Copper Tips included
- Flexible Arm
- 2,5 meter cord
- Heats up in 10 seconds"

REPLACEMENT TIPS FOR SPRUE CLEANER



Part No.	Number	Description	Material
PS6-8	8	Straight Cone	Copper
PS6-9	9	Straight Blade	
PS6-10	10	90° Cone	
PS6-11	11	Straight Cylinder	
PS6-12	12	Straight Cylinder Slim	
PS6-13	13	45° Cone	
PS6-14	14	45° Blade	

COPPER MALLET/POLISHING EQUIPMENT

COPPER AND RAWHIDE MALLET



Part No.	Size	Ø	Weight	Length
TH0208	A	25 mm	355 g	230 mm
TH0210	1	32 mm	710 g	270 mm
TH0212	2	38 mm	1070 g	305 mm
TH0214	3	44 mm	1600 g	305 mm
TH0216	4	50 mm	2380 g	355 mm

Description:

Malleable-iron head fitted with one face of pure copper, the other highly compressed buffalo rawhide.
Wooden Handle

HANDPADS



Part No.	Size	Grade	Colour	UOM
NHP021	155x225 mm.	Fine	Green	10 pcs.
NHP006	155x225 mm.	Very Fine	Maroon	10 pcs.
NHP008	155x225 mm.	Ultra Fine	Light Grey	10 pcs.

Description:

A range of general purpose handpads designed for cleaning and finishing applications

COPPER GAUZE



Part No.	Width	Length
CG30	130	30m.

Description:

Knitted Copper, Reversible Soft Copper perfect for cleaning Screws etc.

MINI GRINDING MACHINE



Part No.	Speed	Voltage	Collet	Foot Control
PP35SET	0-35.000 rpm	115/230 V.	3 mm.	Yes

DIAMOND POINTS SET



Part No.	Grit size	Shank	
DP2030	D100	3 mm.	Set of 30

CARBIDE BURRS SET



Part No.	Cut type	Shank	
CB10S	Double cut	3 mm.	Set of 10

DIAMOND PASTE



Part No.	Micron	Size
MPD1	1	5 gr.
MPD3	3	5 gr.
MPD6	6	5 gr.
MPD8	8	5 gr.
MPD14	14	5 gr.
MPD25	25	5 gr.

Description:

High concentration diamond paste for rapid polishing and repair of moulds.
Use with felt, or wood sticks or points

DIAMOND NEEDLE FILE SET



Part No.	Description	Size	Grit Size
DIAZ-5	Diamond Needle files	140 mm.	D126

Description:
Quality Diamand File Set, usefuf for working with steel, hardened steel, carbide and ceramic/glass materials.

FELT BOBS CYLINDRICAL

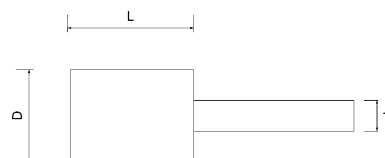

Part No.	D	L	d1	
FIL612C	6	12	3	1 (bag of 10)
FIL1012C	10	12	3	1 (bag of 10)
FIL1219C	12	19	3	1 (bag of 10)
FIL1632C	16	32	3	1 (bag of 10)
FIL1932C	19	32	6	1 (bag of 10)
FIL3238C	32	38	6	1 (bag of 10)

FELT BOBS CONE SHAPE

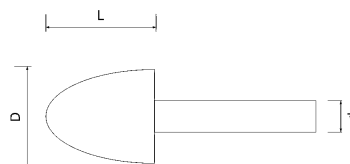

Part No.	D	L	d1	
FIL616K	6	16	3	1 (bag of 10)
FIL1012K	10	12	3	1 (bag of 10)
FIL1219K	12	19	3	1 (bag of 10)
FIL1625K	16	25	3	1 (bag of 10)
FIL1925K	19	25	6	1 (bag of 10)

FELT STICKS HARDENED

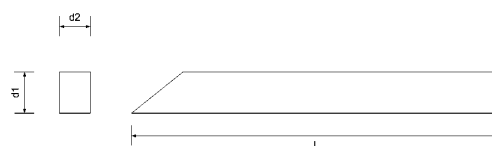

Part No.	d1	d2	L	
FIL66100	6	6	100	1 (bag of 10)
FIL1010150	10	10	150	1 (bag of 10)

HARD WOOD LAPPING STICKS



Part No.	Shape	d1	d2	L	
LS3	Rectangular	3	4,5	150	1 (bag of 10)
LS6	Rectangular	6	4,5	150	1 (bag of 10)
LSS3	Square	3	3	150	1 (bag of 10)
LSS6	Square	6	6	150	1 (bag of 10)
LSR3	Round	ø3	ø3	150	1 (bag of 10)
LSR6	Round	ø6	ø6	150	1 (bag of 10)

BRUSHES

SMALL BORE CLEANING BRUSH (BRASS/NYLON) - 300MM LONG (100MM BRUSH) WITH LOOP HANDLE



Part No. Brass	Part No. Nylon	Diameter	Brush Length	Total length
SB3	SN3	3	100	300
SB4	SN4	4	100	300
SB5	SN5	5	100	300
SB6	SN6	6	100	300
SB8	SN8	8	100	300
SB10	SN10	10	100	300
SB12	SN12	12	100	300
SB15	SN15	15	100	300
SB20	SN20	20	100	300
SB25	SN25	25	100	300

CONDENSER BRUSH



Part No. Brass	Part No. Nylon	Diameter mm	Thread	Brush Length	Total Length
CBB6	CBN6	6	M6	80	115
CBB8	CBN8	8	M6	80	115
CBB10	CBN10	10	M6	80	115
CBB12	CBN12	12	M6	80	115
CBB14	CBN14	14	M6	80	115
CBB16	CBN16	16	M6	80	115
CBB18	CBN18	18	M6	80	115
CBB20	CBN20	20	M6	80	115

Description:

Single Spiral Brush with thread ideal for cleaning inside bores.

BARREL CLEANING BRUSHES



Part No.	Diameter mm	Diameter Inch	Thread	Brush Length	Total Length
BC20	20	3/4"	W 3/8"	100	150
BC22	22	7/8"	W 3/8"	100	150
BC25	25	1"	W 3/8"	100	150
BC28	28	1-1/8"	W 3/8"	100	150
BC30	30	1-1/4"	W 1/2"	100	160
BC35	35	1-1/4"	W 1/2"	100	160
BC40	40	1-1/2"	W 1/2"	100	160
BC44	44	1-1/4"	W 1/2"	100	160
BC50	50	2"	W 1/2"	100	160
BC57	57	2-1/4"	W 1/2"	100	160
BC63	63	2-1/2"	W 1/2"	100	160
BC69	69	2-3/4"	W 1/2"	100	160
BC75	75	3"	W 1/2"	100	160
BC82	82	3-1/4"	W 1/2"	100	160
BC88	88	3-3/8"	W 1/2"	100	160
BC94	94	3-5/8"	W 1/2"	100	160
BC101	101	4"	W 1/2"	100	160
BC125	125	5"	W 1/2"	100	160
BC150*	150	6"	W 1/2"	100	160
BC200*	200	8"	W 1/2"	100	160

Description:

* Single Spiral

Heavy Duty Double Spiral Steel Brush ideal for cleaning Barrel Cylinders of Injection Moulding Machines.

HANDLES AND EXTENSIONS



Part No.	Thread	Type	Length
HD1000	M4	Handle	1000 mm.
ED1000	M4	Extension	1000 mm.
HC1000	M6	Handle	1000 mm.
EC1000	M6	Extension	1000 mm.
HA1000	W 3/8"	Handle	1000 mm.
EA1000	W 3/8"	Extension	1000 mm.
HB1000	W 1/2"	Handle	1000 mm.
EB1000	W 1/2"	Extension	1000 mm.

HAND BRUSH



Part No.	Material	Rows	L	B	A	H
HBM3-5	Brass	3 x 5	150	15	35	15
HBM5-10	Brass	5 x 10	190	24	55	12
HBM4-15	Brass	4 x 15	290	40	140	25

Description:

Allround brushes with wooden handle. Perfect for cleaning surfaces without damaging the Mould parts.

COMPRESSED AIR BLOW GUN

BLOW GUN IN FORGED ALUMINIUM



Part No.	Working Pressure	Tube size	Tube Extended Length	Tube Block Length	Connection
MBG-S	15 Bar	6,5x10	6 m.	490 mm.	R 1/4"

Description:

- Blow gun Sets with Polyurethane Spiral Hose
- Polyamid bend- and scratch protection
- High quality, robust and handy design
- Usefull for all applications

BLOW GUN IN PLASTIC



Part No.	Working Pressure	Tube size	Tube Extended Length	Tube Block Length	Connection
MBG-P	15 Bar	6,5x10	6 m.	490 mm.	R 1/4"

Description:

- Blow gun Sets with Polyurethane Spiral Hose
- Polyamid bend- and scratch protection
- High quality, robust and handy design
- Usefull for all applications

USB BORESCOPE - BH98



Description:

Simple cost effective solution for identifying problems in hard to access areas; Plug the camera in with the USB cable and use the software to take photos / video and measurements on your laptop.

- 7.0mm Diameter Lens with 4 adjustable LED lights (waterproof)
- 6.4mm Diameter Flexible Tube x 830mm long
- 640 x 480 pixels Resolution
- 2 metre USB Cable
- CD with Software (Windows XP/Win 7/Vista)

BORESCOPE - BV99



Description:

- 3.5" TFT LCD Monitor 240 x 320 pixels
- Ø9.8mm Lens with 4 LED lights for Adjustable illumination
- Ø6.8mm Detachable 1000mm Flexible Tube
- Camera Head and Tube IP67 waterproof
- Powered by 4x AA Battery (not included)
- Includes Magnetic Tip / Hook / Mirror Tools, Carry Case

VIDEO BORESCOPE - BV99R



Description:

Advanced design, fl exible and convenient to use this camera allows visual inspection of hard-to-reach areas which can help to identify problems within the mould or damage / wear inside the barrel of the machine.

- 3.5" TFT LCD Monitor 480 x 640 pixels with 5x Digital Zoom
 - Photo, Video, Playback, Built-in speaker and microphone
 - SD Storage Slot, AV Out, USB Interface
 - Ø8.5mm Lens with 4 LED lights for Adjustable illumination
 - Ø6.8mm Detachable 1000mm Flexible Tube
 - Camera Head and Tube IP67 waterproof
- Powered by 4x AA Battery (not included).
Includes Magnetic Tip / Hook / Mirror Tools, Carry Case.

MEASURING TOOLS

DIGITAL CALIPER 0-150 MM - X 0,01 MM/ 1/128", JAW L. 40



11.96 mm

$\frac{1}{128}$ in
FRAC

0.470 in

Part No.	Range (mm)	Resolution	Battery
DC150	0-150	0,01 mm.	1,55V (SR44W)

RADIUS GAUGE - CONCAVE AND CONVEX FORM

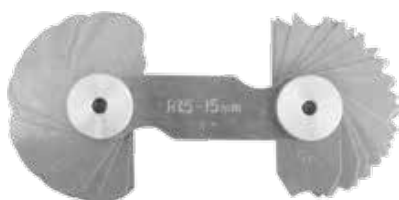

Part No.	Range (mm)	# Blades
RG17	1,0-7,0	17
RG715	7,5-15,0	16
RG1525	15,5-25,0	15

SCHREW PITCH GAUGE - METRIC, WHITWORTH, PIPE THREAD



Part No.	Metric 60° Pitch/mm	Whitworth 55° Pitch/Inch	Pipe Thread 55° Pitch/Inch	# Blades
SPG58	0,25-6,00	62-4	28RG-8RG	58

STEEL RULER 300X30X1,0 MM/INCH - CHROME PLATED



Part No.	Length (mm)	Width (mm)	Thickness (mm)
SR300	300	30	1

HANDHELD MAGNIFIER 2,5X Ø90 MM - GLASS LENS AND 12 X LEDS



Part No.	Magnification	Lens diameter	# LED lights	dimensions
HM90	2,5 X	Ø 90 mm.	12 pcs.	241 x 110 x 14 mm.

Description:

Material (lens): Glass
 Material (body): Metal (Zinc alloy)
 Battery: 2 x AA 1,5 V (NOT included)
 Packing: Black padded case

HANDHELD MAGNIFIER 3X/5X/7X - WITH LED LIGHT

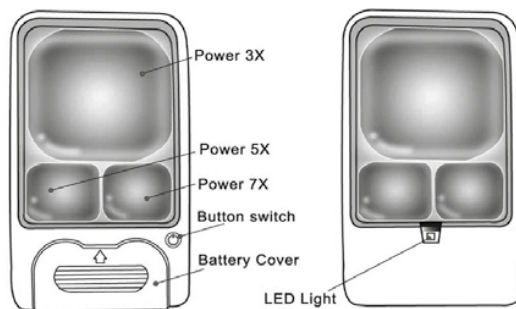

Part No.	Magnification	Lens diameter	# LED lights	dimensions
HM50	3X/5X/7X	50x50/20x25	1	117x61x9 mm.

Description:

Material (body): ABS plastic
 Battery: 2 x CR2032 (included)
 Battery life: Approx. 40-50 hours